

SYRIUS®

TM

PLAZMAPISZTOLYOK

TM-70

TM-125

Technical Data TM-70

Current :	20-70 Amps
Duty Cycle:	70 Amps 50%
Gas:	Air/N2
Gas Pressure:	72-80 PSI (5.0-5.5 bar)
Gas Flow at 70A:	390 scfh (185 lpm)
Pilot :	Electrode to Tip
Ignition:	Without HF

For the correct operation please use:
3-Ways Solenoid Valve, inside orifice
3.5-4.0mm - (0.138-0.157 inches)

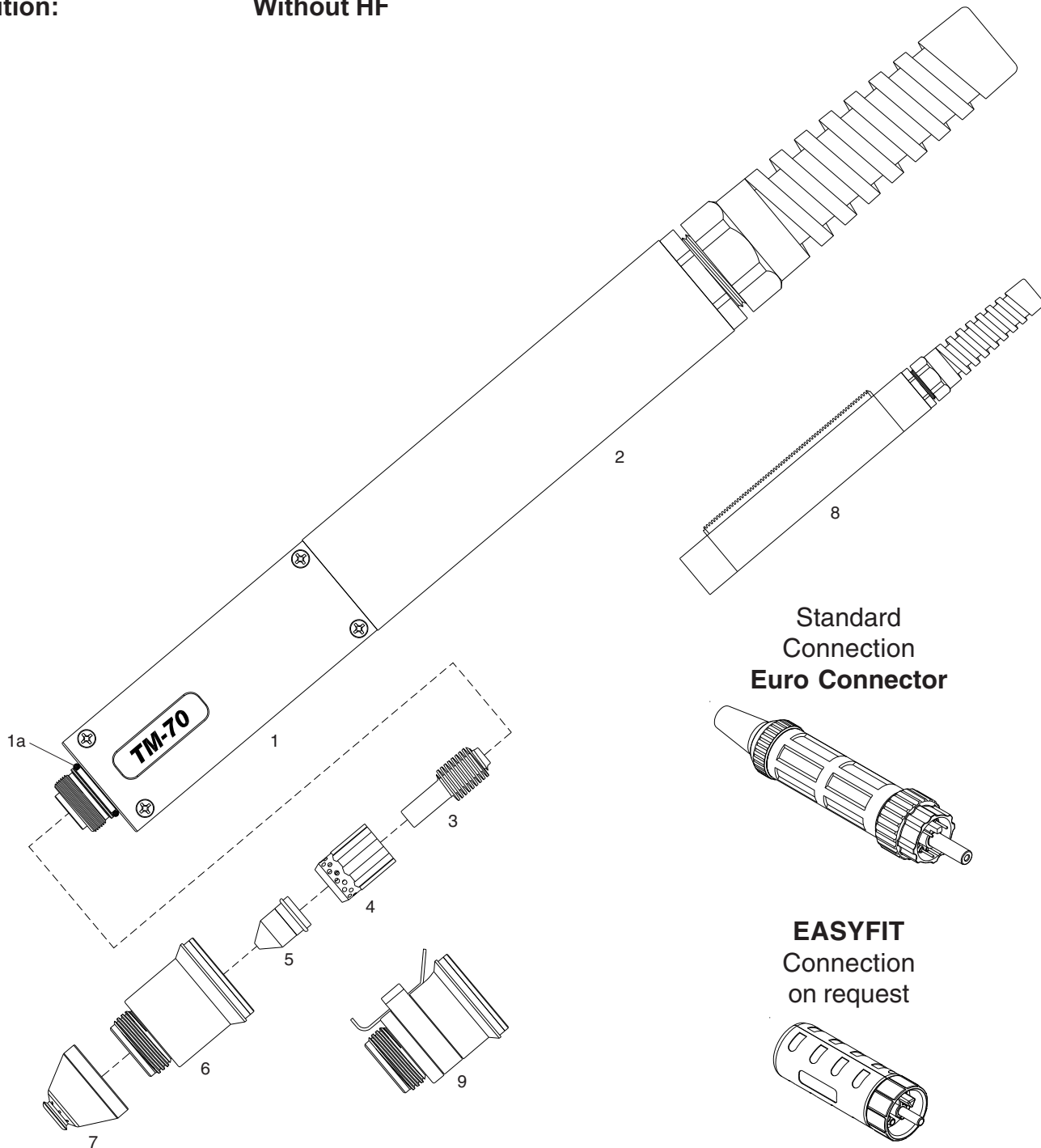

PLASMA CUTTING TORCHES

Replacement Parts **TM-70**

Torch parts

Item	Description	Code
1	● TM-70 Machine Torch Head	03610
1a	● O-Ring	07300.60
2	● Fiberglass Positioning Tube	07218
3	● Electrode	52574
4	Swirl ring	60041E
	● Swirl ring Maximum Life	60041
5	Tip, Contact Cutting, 20-50A	51206
	● Tip, Contact Cutting, 70A	51206.11
6	● Shield Cup Body	60305T
7	● Shield Cap, Machine	51924

● Standard Layout

Torches and Leads

TM-70 Machine Torch, 6m (20ft) Leads, Coaxial Cable	03631CX
TM-70 Machine Torch, 12m (40ft) Leads, Coaxial Cable	03636CX
TM-70 Lead Assembly, Machine, 6m (20 ft) Length, Coaxial Cable	03691CX
TM-70 Lead Assembly, Machine, 12m (40 ft) Length, Coaxial Cable	03696CX

Accessories

8	Fiberglass Positioning Tube With Rack	07219
9	Shield Cup Body OHMIC	60305TH

Torches with different connectors available on request.

Monogas

Air or N₂

TM-125

Technical Data

Current :	20-70 Amps
Duty Cycle:	70 Amps 50%
Gas:	Air/N₂
Gas Pressure	
- Cutting:	72-80 PSI (5.0-5.5 bar)
- Gouging:	58-65 PSI (4.0-4.5 bar)
Gas Flow at 70A:	390 scfh (185 lpm)
Post Flow Time :	45 sec
Pilot :	Electrode to Tip (15-18A)
Ignition:	Without HF

For the correct operation please use:
 3-Ways Solenoid Valve, inside orifice
 4.5-5.5mm - (0.178-0.217 inches)

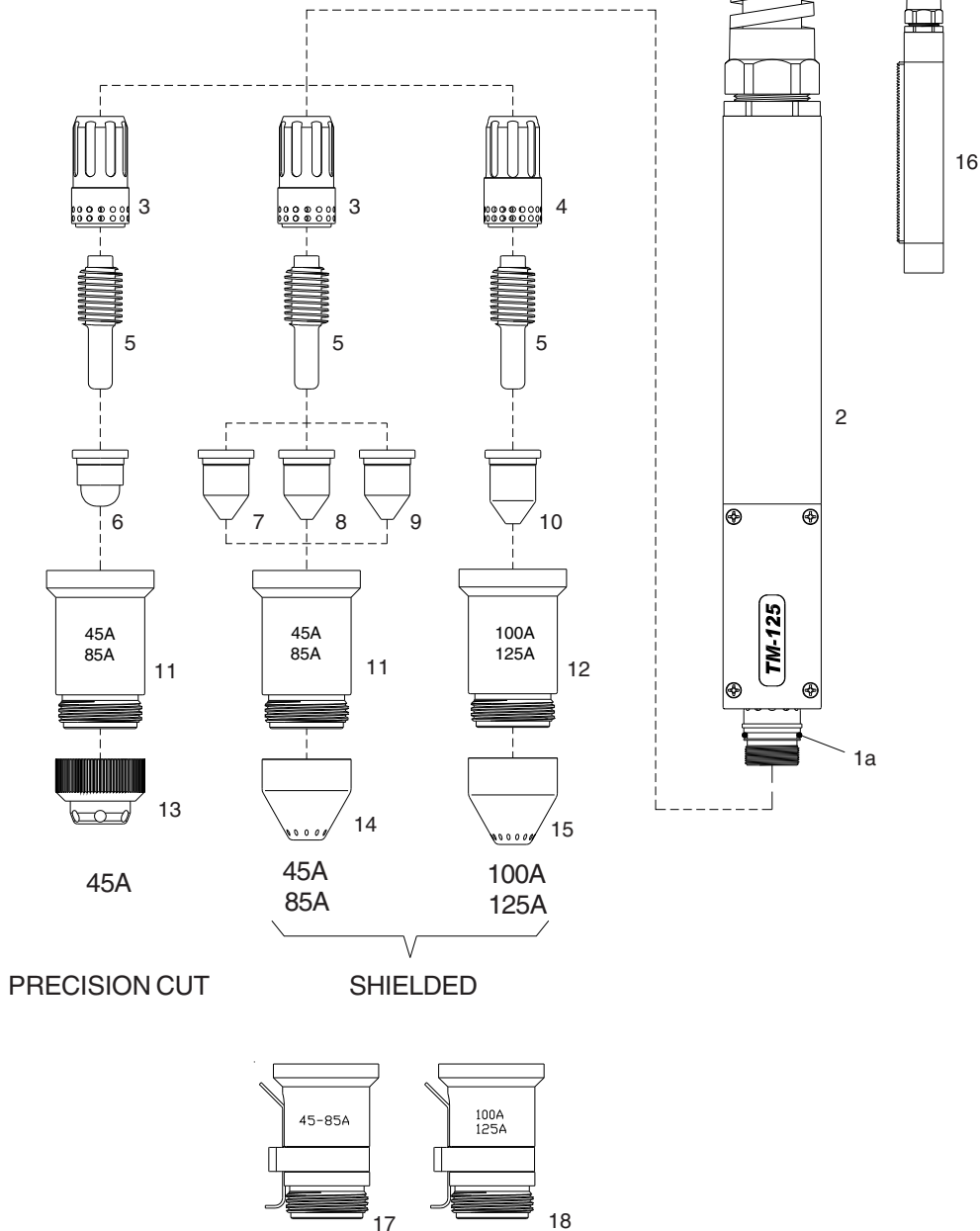

PLASMA CUTTING TORCHES

Air or N₂

Replacement Parts

Torch parts

<i>Item</i>	<i>Description</i>	<i>Code</i>
1	● TM-125 Machine Torch Head	03710
1a	● O-Ring	03700.60
2	● Fiberglass Positioning Tube	07218
3	Swirl ring, 45-85A	60042E
	Swirl ring, 45-85A Maximum Life	60042
4	Swirl ring, 100-125A	60040E
	● Swirl ring, 100-125A Maximum Life	60040
5	● Electrode, 45-125A	52677
	Electrode, 45-125A, BiMetal	52677BM
6	Tip, Cutting, 45A Precision Cut	51415
7	Tip, Cutting, 45A	51416
8	Tip, Cutting, 65A	51417
9	Tip, Cutting, 85A	51418
10	Tip, Cutting, 105A	51419
	● Tip, Cutting, 125A	51419.16
11	Shield Cup Body, 45-85A	60309TA
12	● Shield Cup Body, 100-125A	60309TC
13	Shield Cap, 45A Precision Cut	51929
14	Shield Cap, Machine, 45-85A	51922
15	● Shield Cap, Machine, 100-125A	51927

Torches and Leads

TM-125 Machine Torch, 6m (20 ft) Leads, Coaxial Cable	03731CX
TM-125 Machine Torch, 12m (40 ft) Leads, Coaxial Cable	03736CX

Accessories

16	Fiberglass Positioning Tube With Rack	07219
17	Shield Cup Body, 45-85A OHMIC	60309THA
18	Shield Cup Body, 100-125A OHMIC	60309THC