

SYRIUS®

UPM-105 180°

UPM-125 180°

UPM-160 180°

Jobb teljesítmény

Tisztább vágás

Gyorsabb munka

UPM-105

Hybrid

Technical Data

Current : 20-105 Amps
 Duty Cycle: 105 Amps at 60%
 Gas: Air/N2
 Gas Pressure
 - Cutting: 72-80 PSI (5.0-5.5 bar)
 - Gouging: 50-65 PSI (3.5-4.5 bar)
 Gas Flow at 105A: 510 SCFH (240 lpm)
 Post Flow Time : 45 sec
 Pilot : Electrode to Tip (12-20A)
 Ignition: Without HF

For the correct operation please use:
 3-Ways Solenoid Valve, inside orifice
 3.5-4.0mm - (0.138-0.157 inches)

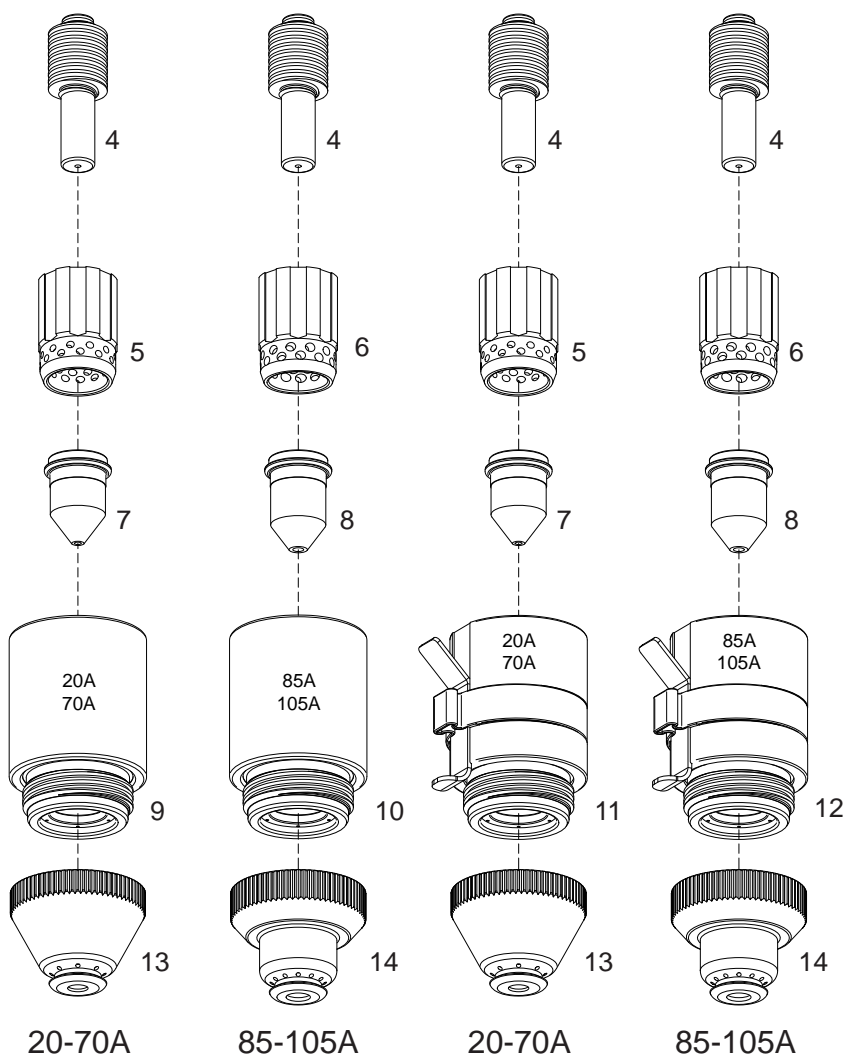

Shielded

Shielded with ohmic

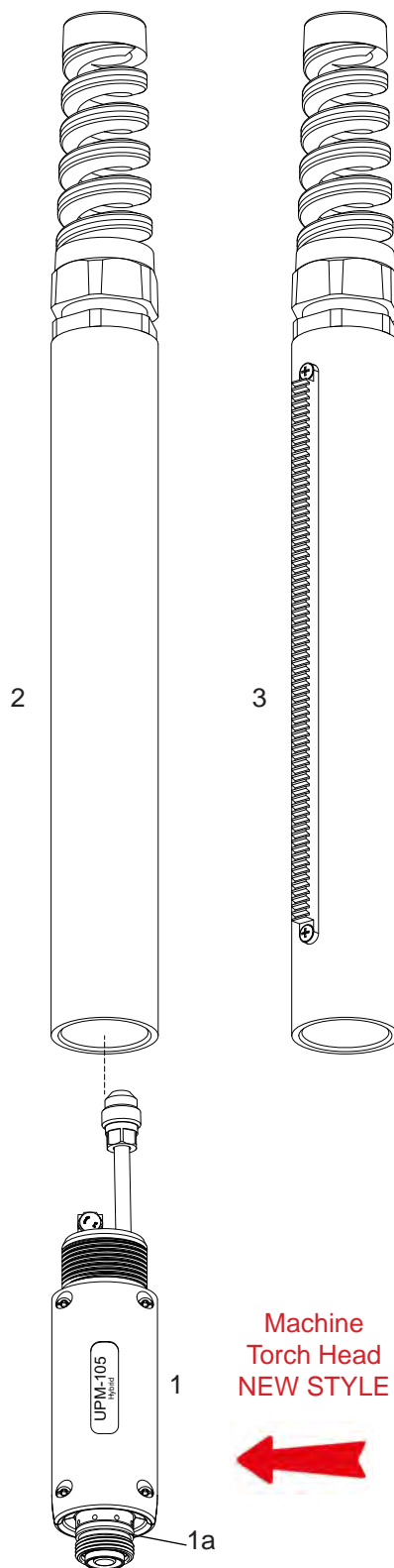

Machine
Torch Head
NEW STYLE



UPM-105

Hybrid

Air or N₂

UPM-105 ■ Standard Layout

UNICUT®



see
page
15

FLATCUT®

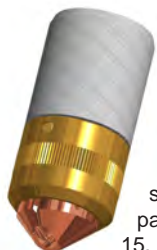

see
pages
15, 18-19

Replacement Parts

Torch parts

Item	Description	Code
1	■ UPM-105 180° Machine Torch Head	05810
1a	■ O-Ring	07300.60
2	■ Fiberglass Positioning Tube	07218
3	■ Fiberglass Positioning Tube With Rack	07219
4	■ Electrode, 20-105A	52574
5	Swirl ring, 20-105A Maximum Life	60041
	Swirl ring, 20-105A ECO	60041E
6	■ Swirl ring, 85-105A Maximum Life	60024
	Swirl ring, 85-105A ECO	60024E
7	Tip, Cutting, 45A	51206
	Tip, Cutting, 70A	51206.11
8	Tip, Cutting, 85A	51223.13
	■ Tip, Cutting, 105A	51223.15
9	Shield Cup Body, 20-70A Maximum Life	60305
	Shield Cup Body, 20-70A ECO	60305E
10	■ Shield Cup Body, 85-105A Maximum Life	60329
	Shield Cup Body, 85-105A ECO	60329E
11	Shield Cup Body, 20-70A Ohmic Maximum Life	60305H
	Shield Cup Body, 20-70A Ohmic ECO	60305HE
12	Shield Cup Body, 85-105A Ohmic Maximum Life	60329H
	Shield Cup Body, 85-105A Ohmic ECO	60329HE
13	Shield Cap, Machine, 45-85A	51922
14	■ Shield Cap, Machine, 100-125A	51927

Complete Torches Maximum Life

UPM-105 75°, Machine Torch, 6m (20 ft) Leads,
Coaxial Cable, Euro Connector 05831CX

UPM-105 75°, Machine Torch, 12m (40 ft) Leads,
Coaxial Cable, Euro Connector 05836CX

Air Filter AT-1000



see
page
28

Torches with different connectors available on request.

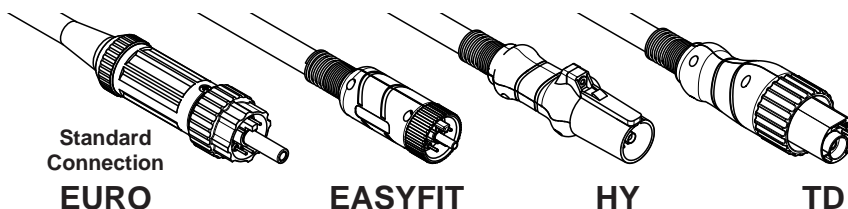

UPM-125

Hybrid

Technical Data

Current : 40-125 Amps
 Duty Cycle: 125 Amps at 60%
 Gas: Air/N₂
 Gas Pressure
 - Cutting: 72-87 PSI (5.0-6.0 bar)
 - Gouging: 50-65 PSI (3.5-4.5 bar)
 Gas Flow at 125A: 630 SCFH (295 lpm)
 Post Flow Time : 45 sec
 Pilot : Electrode to Tip (15-22A)
 Ignition: Without HF

For the correct operation please use:
 3-Ways Solenoid Valve, inside orifice
 4.5-5.5mm - (0.178-0.217 inches)

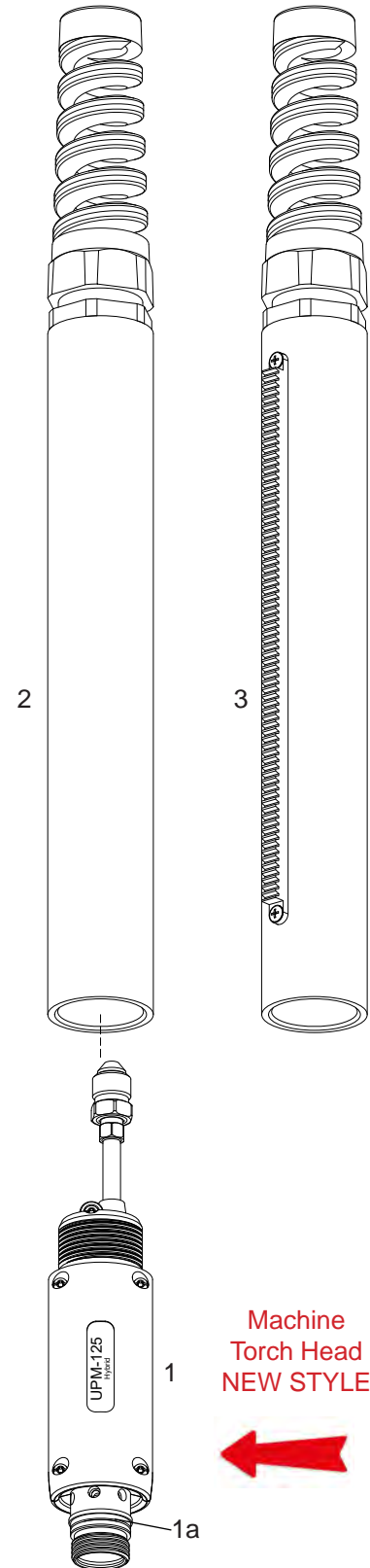
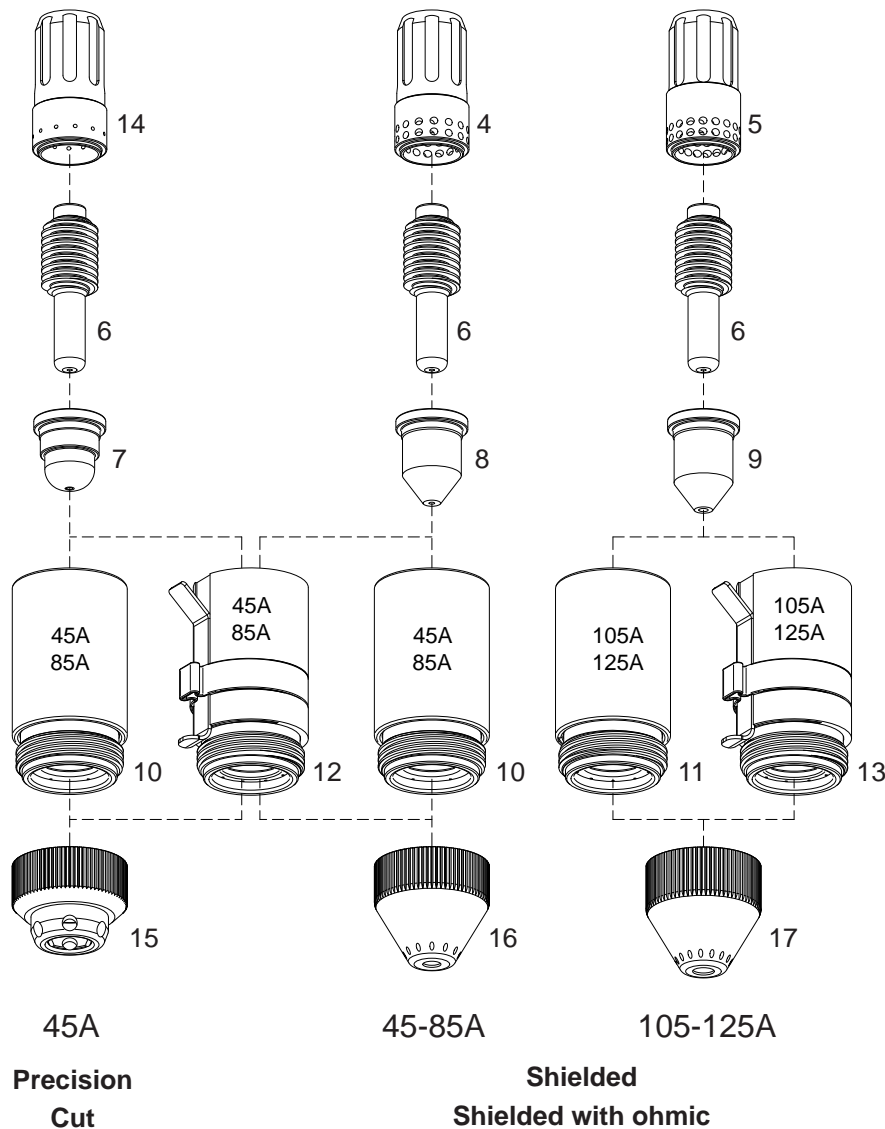

UPM-125

Hybrid

Air or N₂

UPM-125 ■ Standard Layout

UNICUT®



see
page
17

FLATCUT®

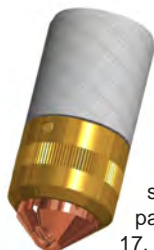

see
pages
17, 20-21

Replacement Parts

Torch parts

Item	Description	Code
1	■ UPM-125 180° Machine Torch Head	05910
1a	■ O-Ring	07300.60
2	■ Fiberglass Positioning Tube	07218
3	Fiberglass Positioning Tube With Rack	07219
4	Swirl ring, 45-85A Maximum Life	60042
	Swirl ring, 45-85A ECO	60042E
5	■ Swirl ring, 100-125A Maximum Life	60040
	Swirl ring, 100-125A ECO	60040E
6	■ Electrode, 45-125A	52677
	Electrode, 45-125A, BiMetal (on request)	52677BM
7	Tip, Cutting, 45A, Precision Cut	51415
8	Tip, Contact Cutting, 45A	51416
	Tip, Contact Cutting, 65A	51417
	Tip, Contact Cutting, 85A	51418
9	Tip, Contact Cutting, 105A	51419
	■ Tip, Contact Cutting, 125A	51419.16
10	Shield Cup Body, 45-85A Maximum Life	60309AV
	Shield Cup Body, 45-85A ECO	60309A
11	■ Shield Cup Body, 100-125A Maximum Life	60309BV
	Shield Cup Body, 100-125A ECO	60309B
12	Shield Cup Body, 45-85A Ohmic Maximum Life	60309HA
13	Shield Cup Body, 100-125A Ohmic Maximum Life	60309HB
14	Swirl ring, 45A, Precision Cut, Maximum Life	60032
15	Shield Cap, 45A, Precision Cut	51929
16	Shield Cap, Machine, 45-85A	51922
17	■ Shield Cap, Machine, 100-125A	51927

Complete Torches Maximum Life

UPM-125 75°, Machine Torch, 6m (20 ft) Leads,
Coaxial Cable, Euro Connector 05931CX

UPM-125 75°, Machine Torch, 12m (40 ft) Leads,
Coaxial Cable, Euro Connector 05936CX

Air Filter AT-1000



see
page
28

Torches with different connectors available on request.

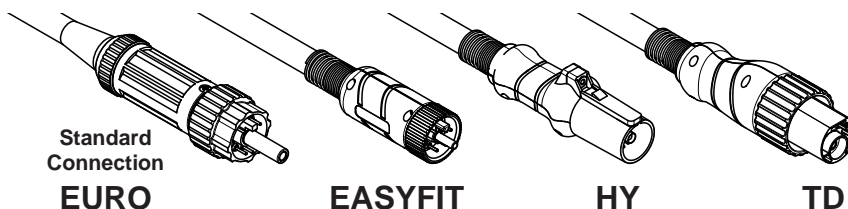

UPM-160

Hybrid

Technical Data

Current : 30-160 Amps
 Duty Cycle: 160 Amps at 60%
 Gas: Air/N2
 Gas Pressure
 - Cutting: 72-87 PSI (5.0-6.0 bar)
 - Gouging: 40-46 PSI (3.0-3.5 bar)
 Gas Flow at 125A: 850 SCFH (420 lpm)
 Post Flow Time : 45 sec
 Pilot : Electrode to Tip (22-25A)
 Ignition: Without HF

For the correct operation please use:
 3-Ways Solenoid Valve, inside orifice
 4.5-5.5mm - (0.178-0.217 inches)

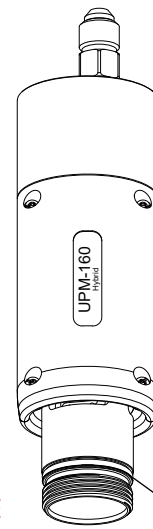
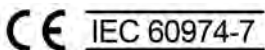

Patent Pending

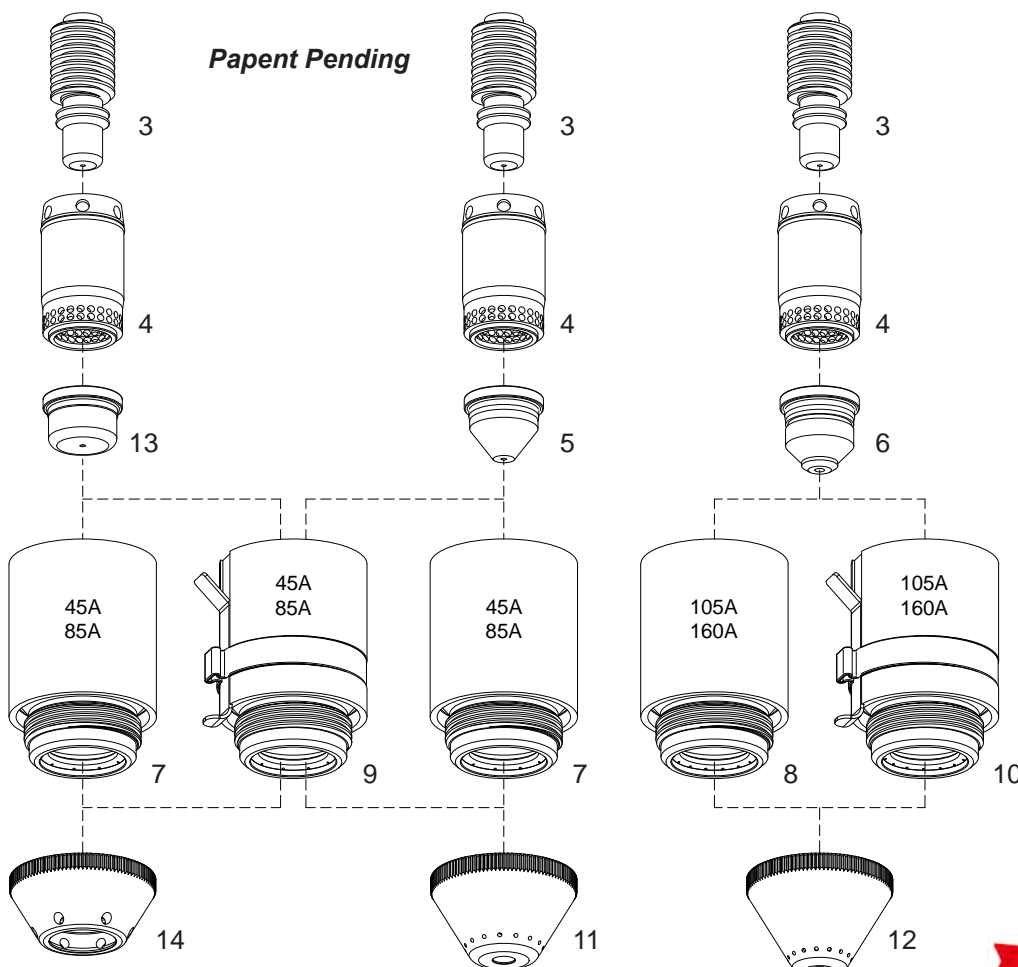

Machine
 Torch Head
 NEW STYLE

45A
 Precision
 Cut

45-85A
 Shielded
 Shielded with ohmic

105-160A

UPM-160

Hybrid

Air or N₂

UPM-160
■ Standard Layout

FLATCUT®

see
pages
22

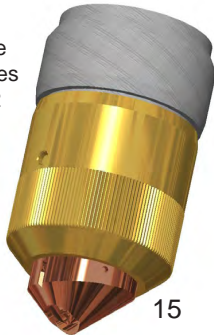

Replacement Parts

Torch parts

Item	Description	Code
1	■ UPM-160 180° Machine Torch Head	03910
1a	O-Ring	03900.60
2	■ Fiberglass Positioning Tube	03916
3	■ Electrode Patent Pending Electrode, BiMetal , Patent Pending (on request)	52678 52678BM
4	■ Swirl ring Maximum Life Swirl ring ECO	60039 60039E
5	Tip, Cutting, 45A	51420
	Tip, Cutting, 65A	51421
	Tip, Cutting, 85A	51422
6	Tip, Cutting, 105-125A	51425
	■ Tip, Cutting, 160A	51426
7	Shield Cup Body, 45-85A	60311TA
8	■ Shield Cup Body, 105-160A	60311TB
9	Shield Cup Body, 45-85A Ohmic	60311THA
10	Shield Cup Body, 105-160A Ohmic	60311THB
11	Shield Cap, Machine, 45-85A	51918T
12	■ Shield Cap, Machine, 105-160A	51919T
13	Tip, 30-45A, Precision Cut	51428
14	Deflector, Precision Cut	51915
15	Standard KIT FLATCUT 85-125A NEW Standard KIT FLATCUT 130-160A NEW	53637 53638

Complete Torches Maximum Life

UPM-160 180° Machine Torch, 6m (20 ft) Leads,
Coaxial Cable, Euro Connector. 03931CX

UPM-160 180° Machine Torch, 12m (40 ft) Leads,
Coaxial Cable, Euro Connector. 03936CX

Air Filter
AT-1000



see
page
28

Torches with different connectors available on request.

