

KOMATSU®

G 940®

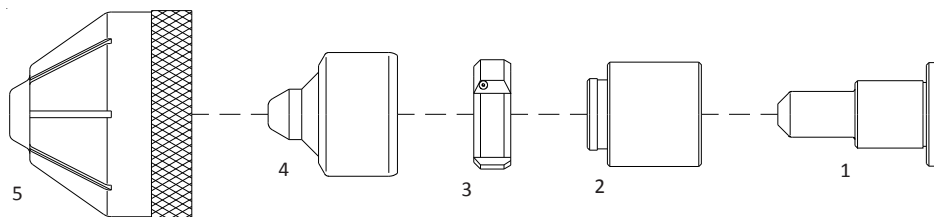

No.	Ref.	Code	Description	Pkg.	No.	Ref.	Code	Description	Pkg.
1	7848-60-5330	52850	Electrode	5	4	7848-60-5170	51499	Tip \varnothing 0.5	5
2	7848-60-5350	80050	Insulating sleeve	2		7848-60-5130	51500	Tip \varnothing 0.6	5
3	7848-60-5360	60450	Swirl ring	2		7848-60-5160	51501	Tip \varnothing 0.7	5
4	7848-60-5150	51498	Tip \varnothing 0.4	5	5	7848-60-5110	60550	Conical retaining cap	1

KOMATSU®

G 990®

ON REQUEST

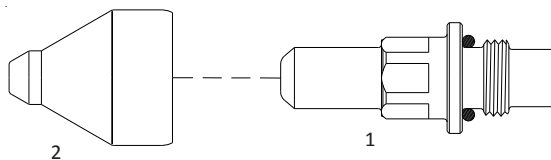

No.	Ref.	Code	Description	Pkg.	No.	Ref.	Code	Description	Pkg.
1	7848-65-5920	52855	Electrode	5	2	7848-65-5180	51451	Tip \varnothing 1.1	5
2	7848-65-5160	51450	Tip \varnothing 0.8	5		969-95-40211	51452	Tip \varnothing 1.3	5

KOMATSU®

G 9150®

ON REQUEST

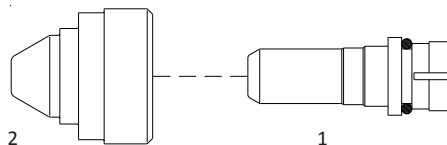

No.	Ref.	Code	Description	Pkg.	No.	Ref.	Code	Description	Pkg.
1	969-95-24310	52853	Electrode	5	2	969-95-24180	51457	Tip \varnothing 1.1	5
2	969-95-24190	51456	Tip \varnothing 0.8	5		969-95-24130	51458	Tip \varnothing 1.3	5